



YML01CR-EBxxF LENS



PRODUCT DESCRIPTION

Features:

- High efficiency >93%
- Available in 11 beam pattern
- Optimized for uniform effects
- Lens material Optical grade PMMA
- Lens with holder

Typical applications:

- Stage Lighting
- Street Lights
- Decorative Light
- Down Light

TABLE OF CONTENTS

General Information2
Usage and Maintenance2
2D Drawings 3-13
Optical Characteristics (for 3535 led) 3-13
Package Information14
Product Nomenclature15



General Information (T_J = 25°C)

- Compatible Led Type:

The YML01CR-EBxxF single lens is optimized for 3535 led .

- Beam Angle Type:

An optimized profile integrate different front shape enabel the general of eleven lens model:oval beam (10 deg;15 deg;25 deg;30 deg;40 deg;60 deg;10*30 deg;10*45deg;10*65 deg;10*70 deg;20*65 deg)⁽¹⁾

- The Way to Assembly:

The lens should be assembled to the PCB board or MCPCB upon LEDs which provides the most appropriate related position,so as to achieve the best uniform results.

*** Manually installation or if necessary thermal glue are recommended.**

- Fuction:

YML01CR-EBxxF provides excep tional color mixing result with the highest efficiency through careful enginnering and precision manufacturing process.

Usage and Maintenance

- 1.Clean lenses with mild soap and water and a soft cloth.
- 2.Don't use any commercial cleaning solvents on lenses,like alcohol.
- 3.Operating temperature -40℃~+80℃(upper limit +90℃)
- 4.please handle or install lenses with wearing gloves,skin oils may damage lens or optical characteristic.

Notes:

(1) Typical beam divergence will be affected by different LED manufacturers.



2D Drawings (unit:mm)

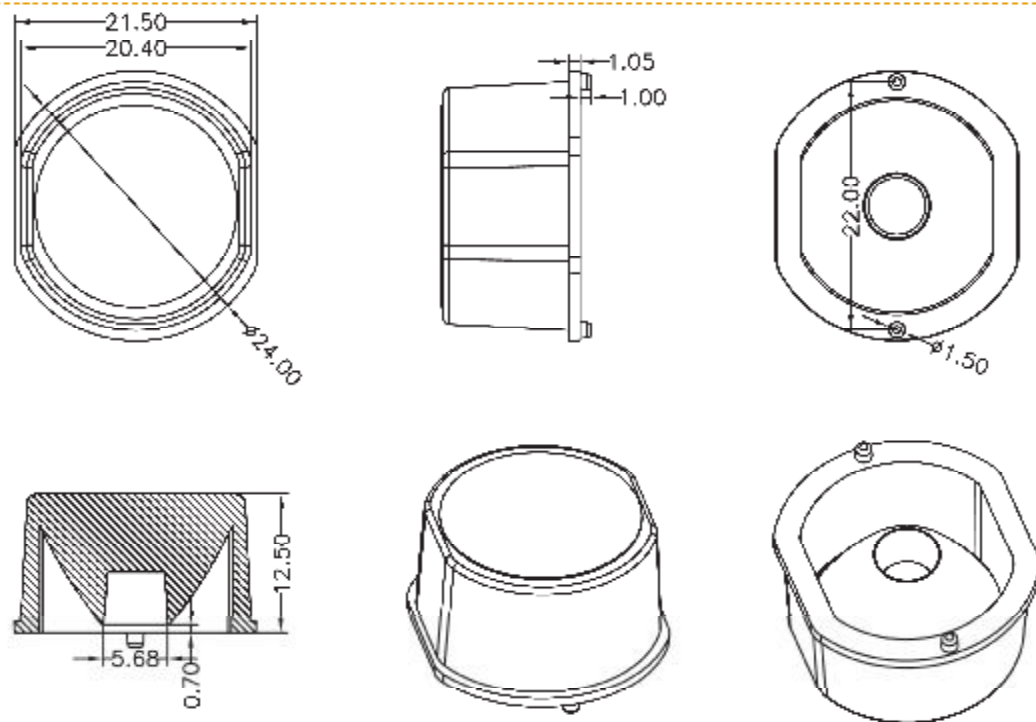

LENS

Optical Characteristics (for 3535 LED)

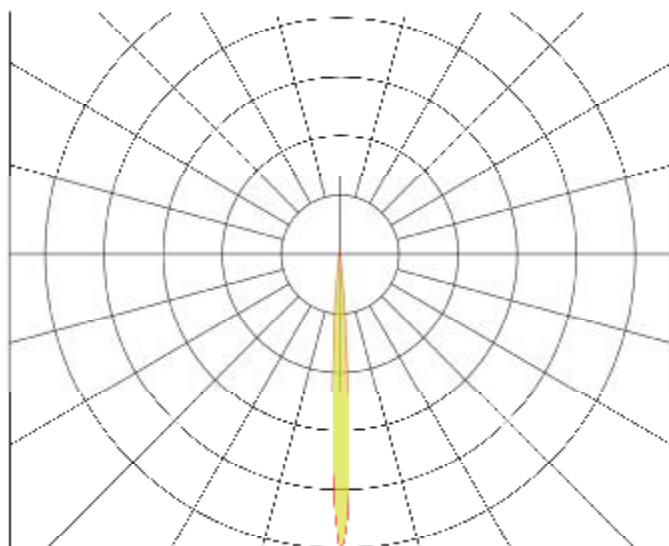

Note: The CREE XP-E LED emitter flux is 120lm @350mA

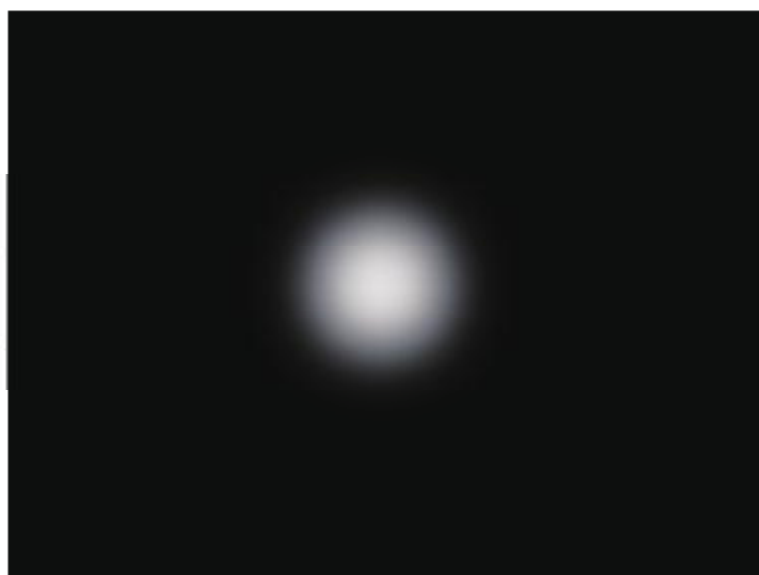



2D Drawings (unit:mm)

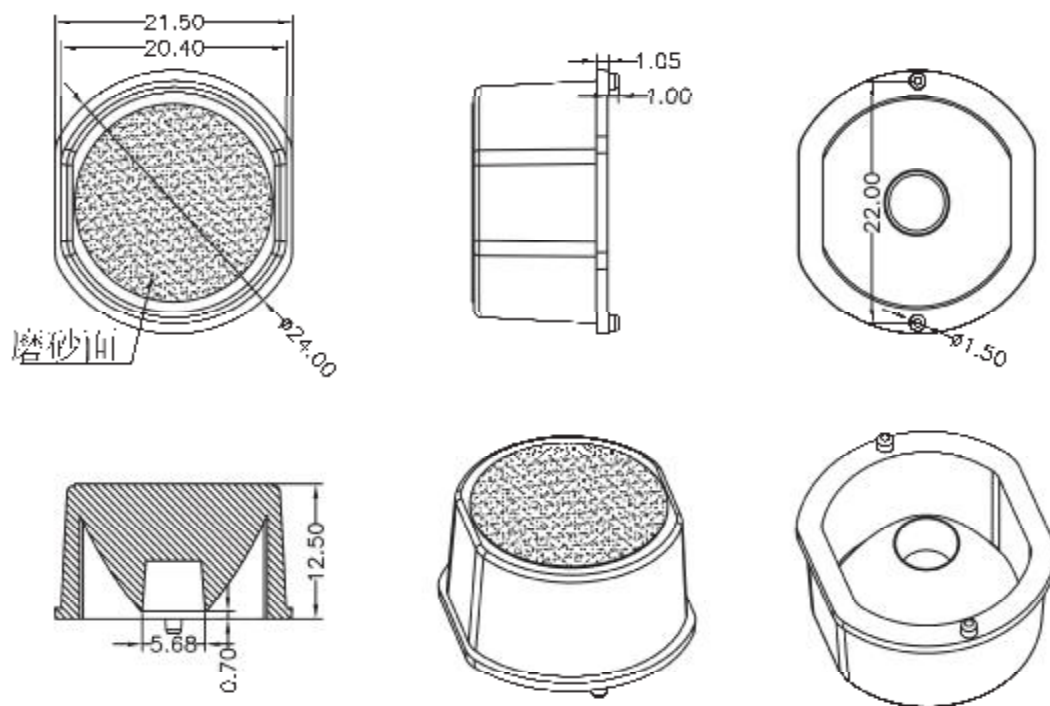

LENS

Optical Characteristics (for 3535 LED)

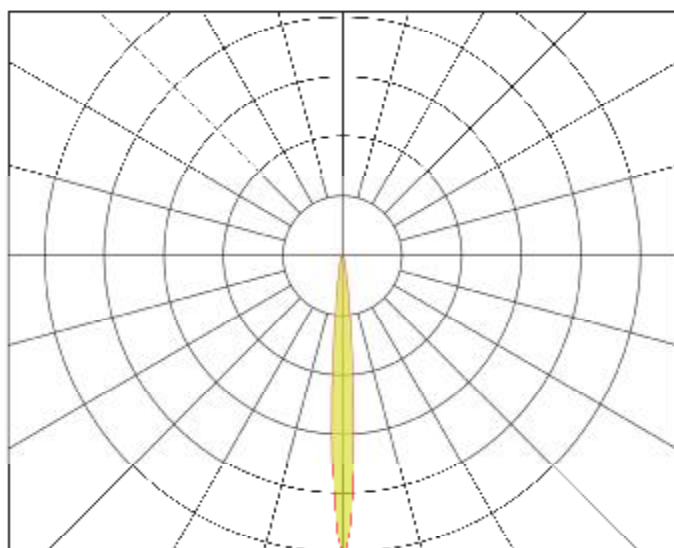

Note: The CREE XP-E LED emitter flux is 120lm @350mA





2D Drawings (unit:mm)

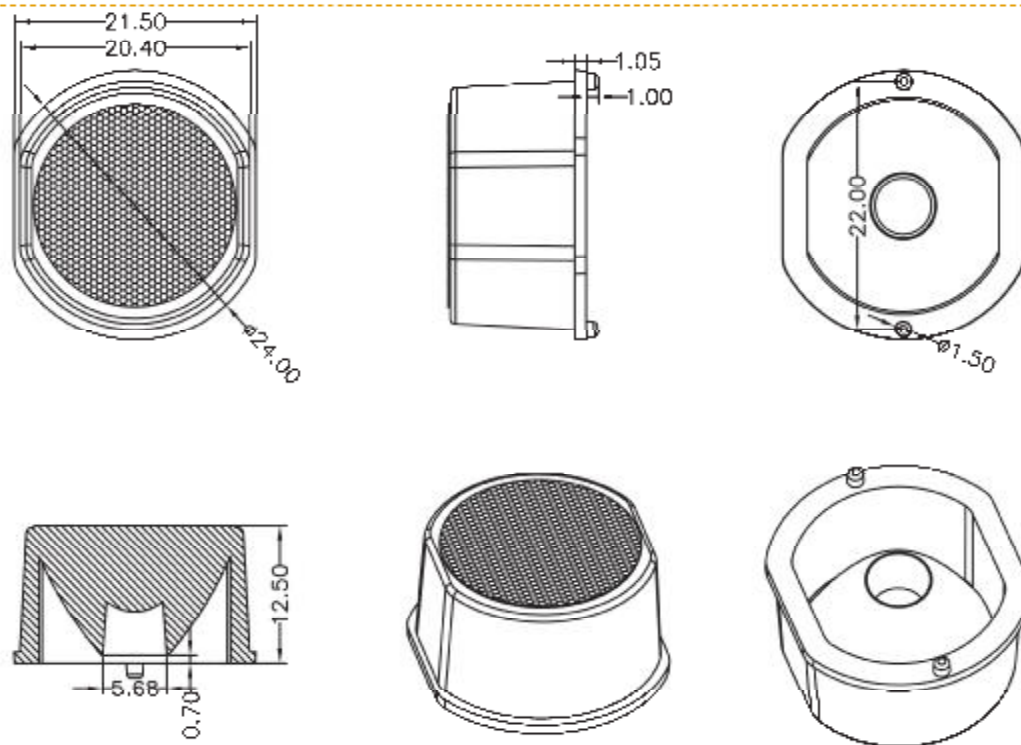

LENS

Optical Characteristics (for 3535 LED)

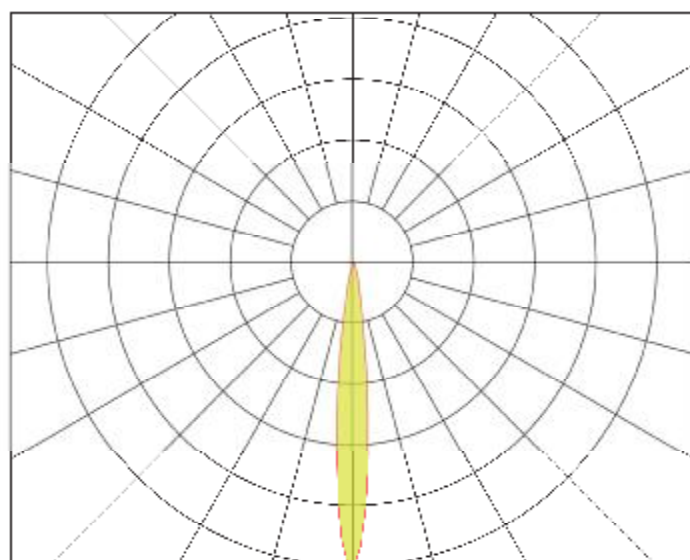

Note: The CREE XP-L LED emitter flux is 120lm @350mA





2D Drawings (unit:mm)

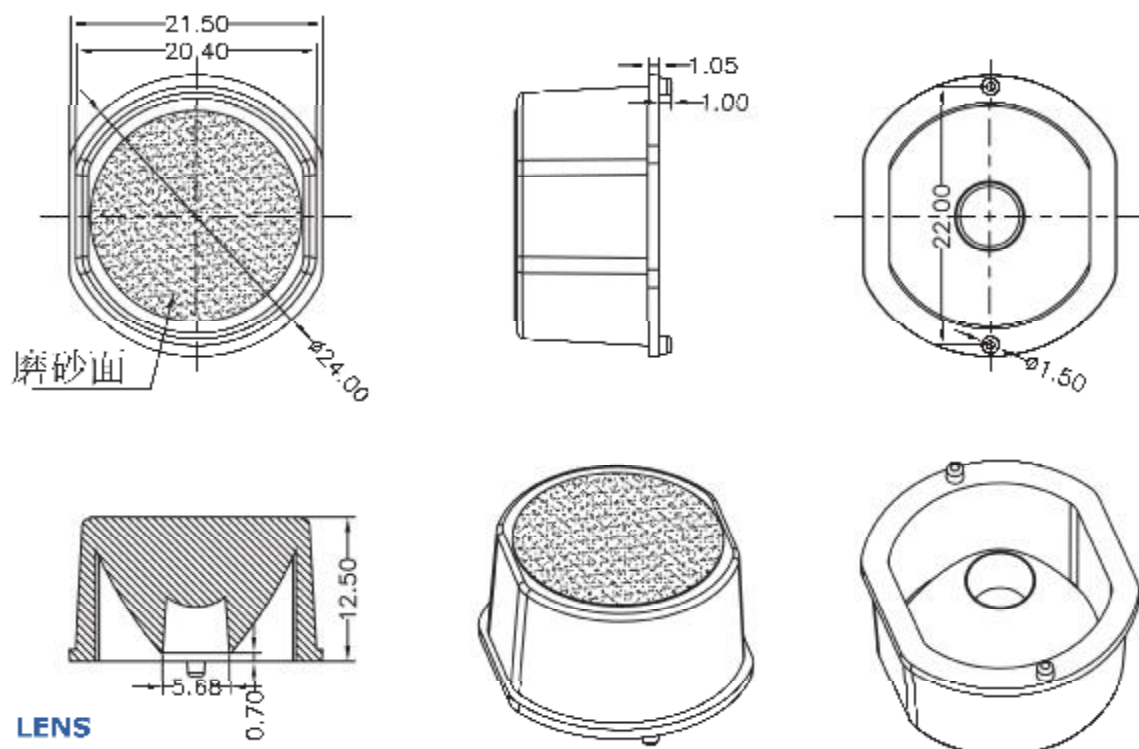

Optical Characteristics (for 3535 LED)

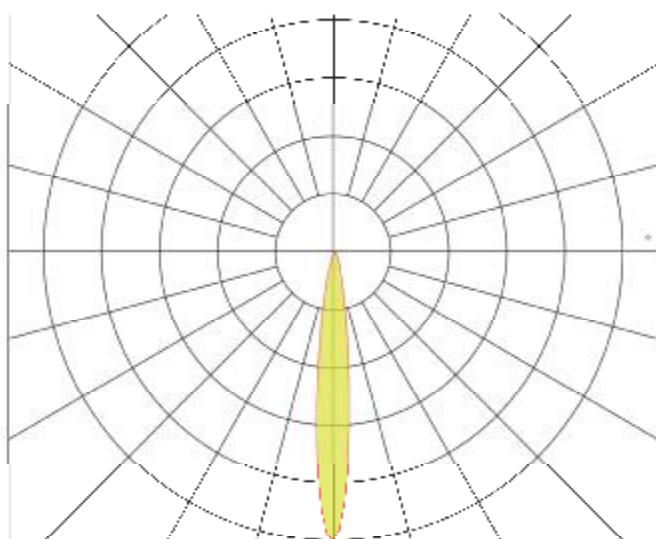

Note: The CREE XP-E LED emitter flux is 120lm @350mA



2D Drawings (unit:mm)

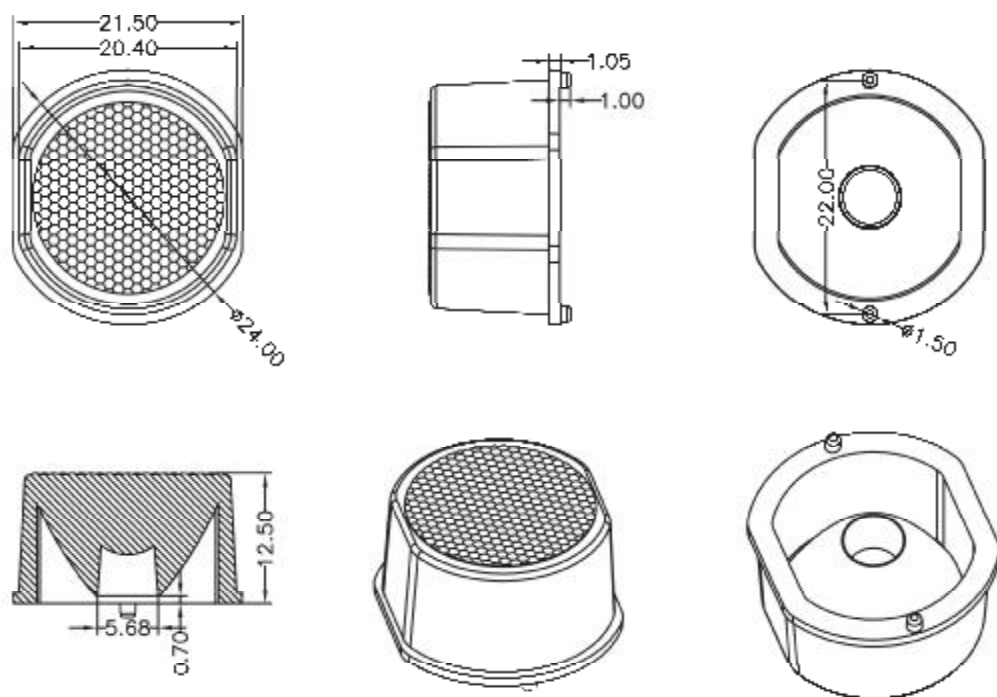

LENS

Optical Characteristics (for 3535 LED)

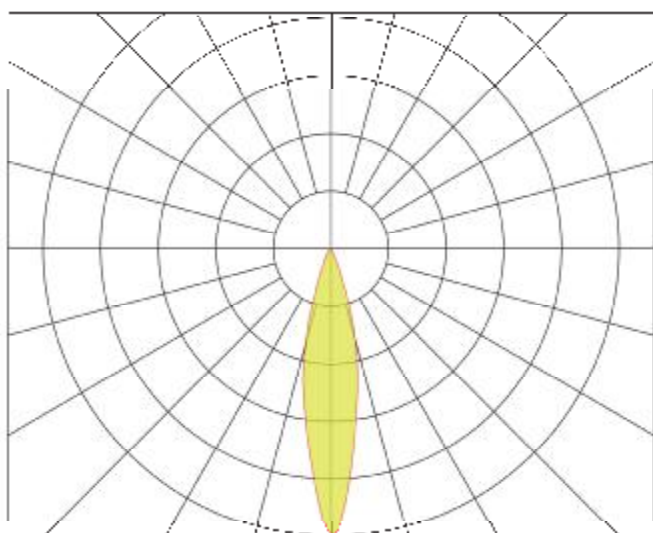

Note: The CREE XP-E LED emitter flux is 120lm @350mA





2D Drawings (unit:mm)

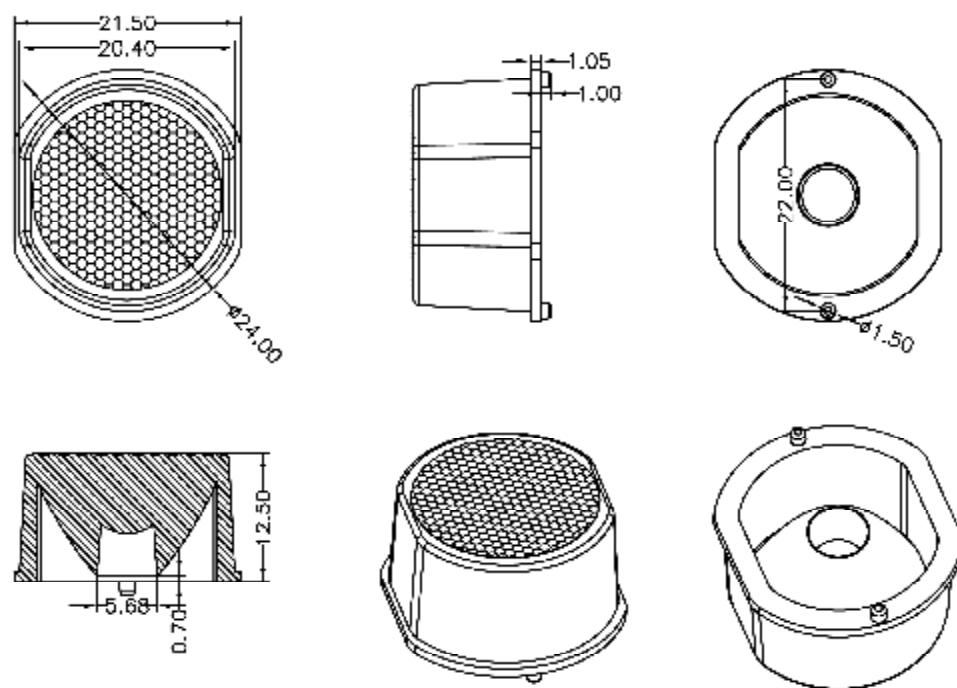

LENS

Optical Characteristics (for 3535 LED)

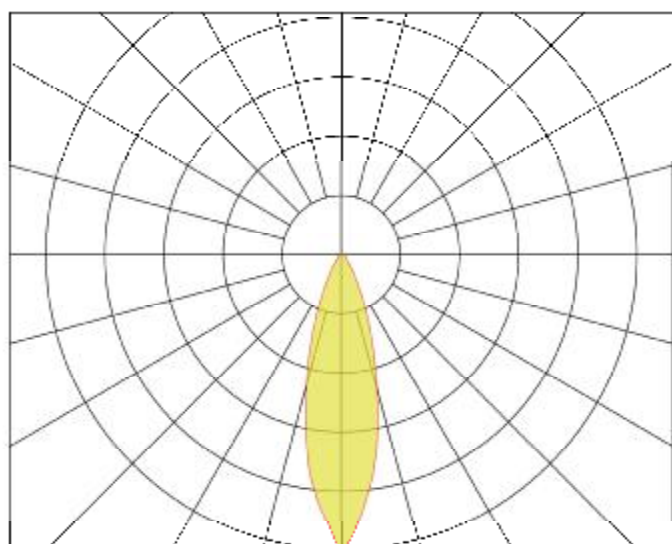

Note: The CREE XP-E LED emitter flux is 120lm @350mA

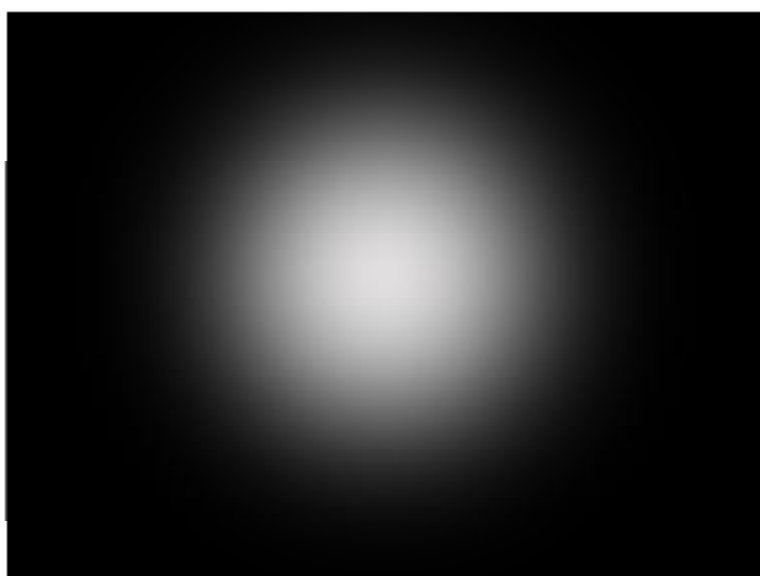



2D Drawings (unit:mm)

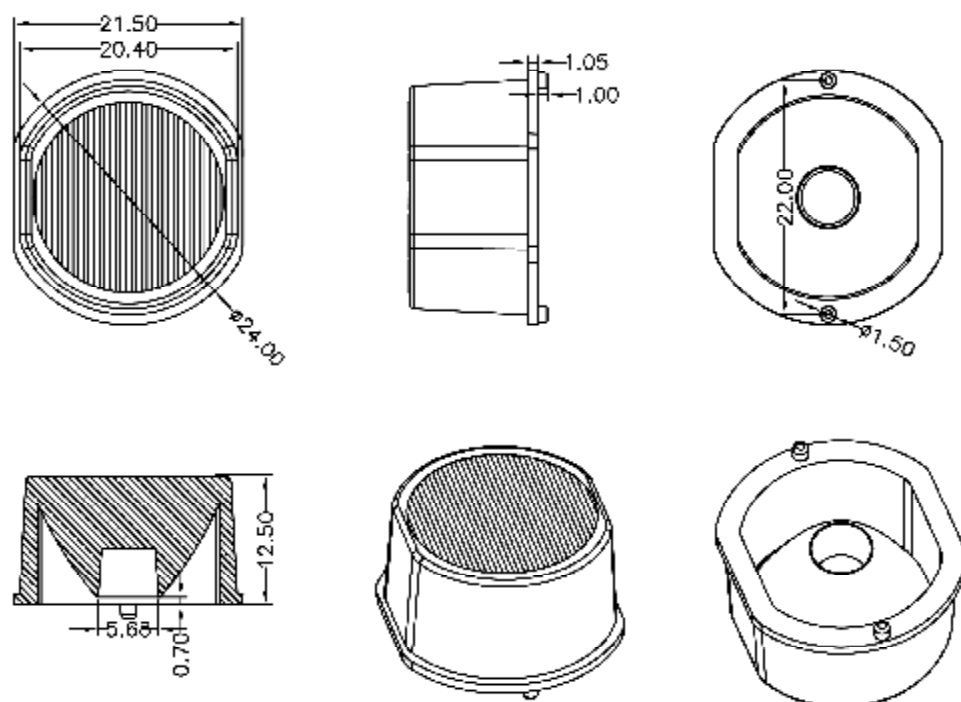

LENS

Optical Characteristics (for 3535 LED)

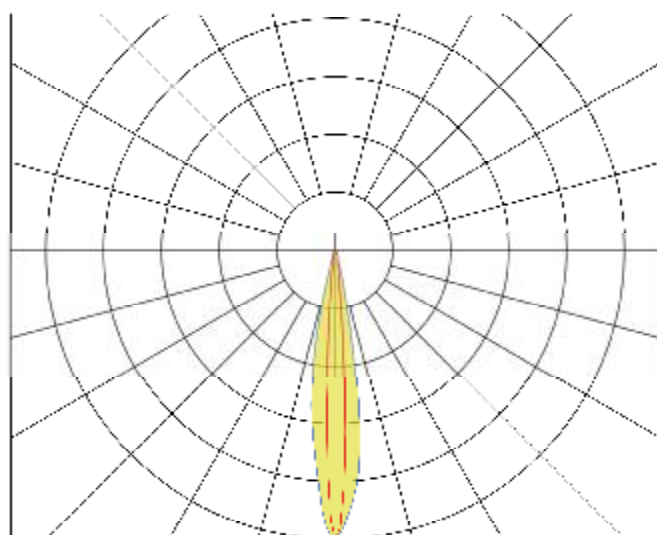

Note: The CREE XP-E LED emitter flux is 120lm @350mA

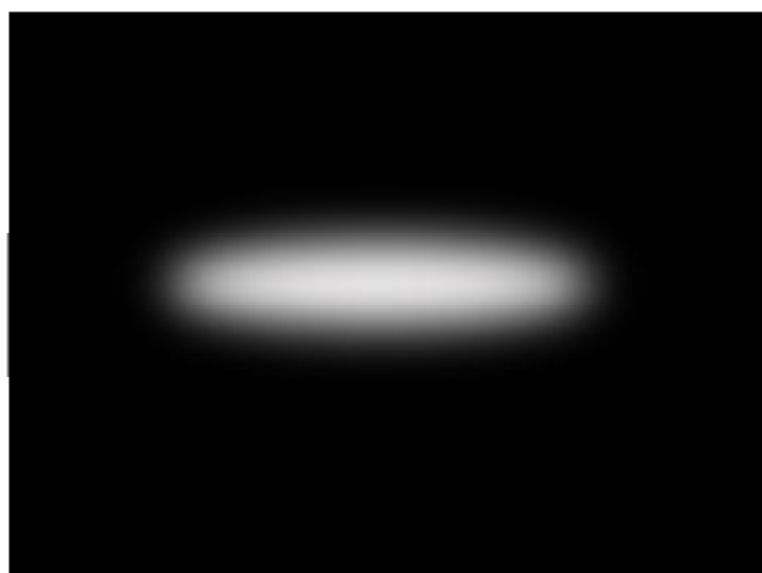



2D Drawings (unit:mm)

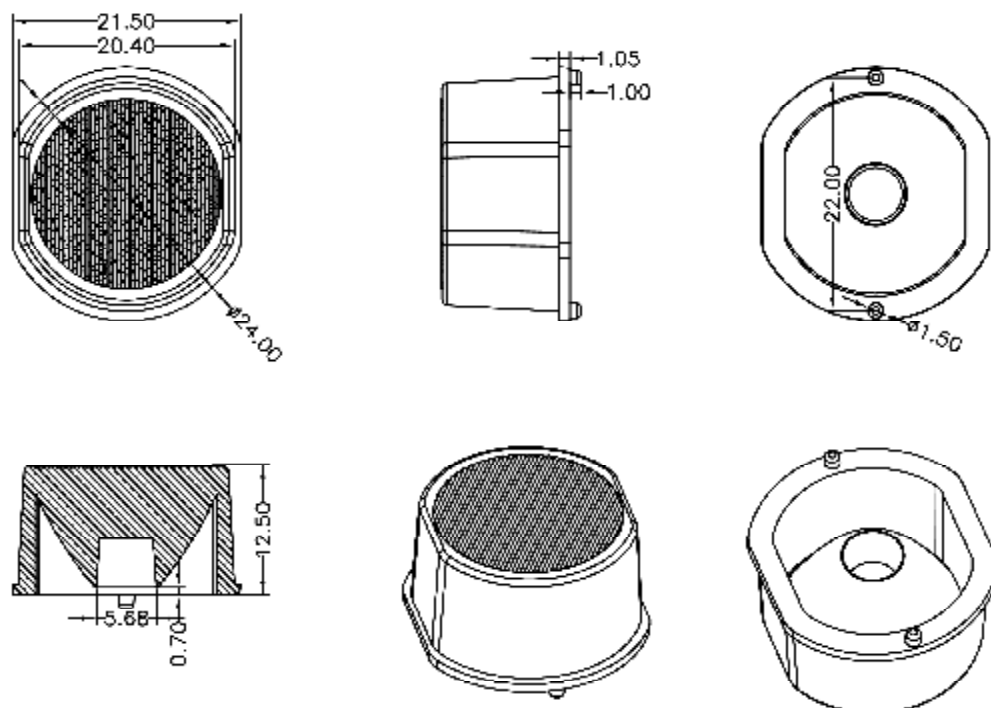

LENS

Optical Characteristics (for 3535 LED)

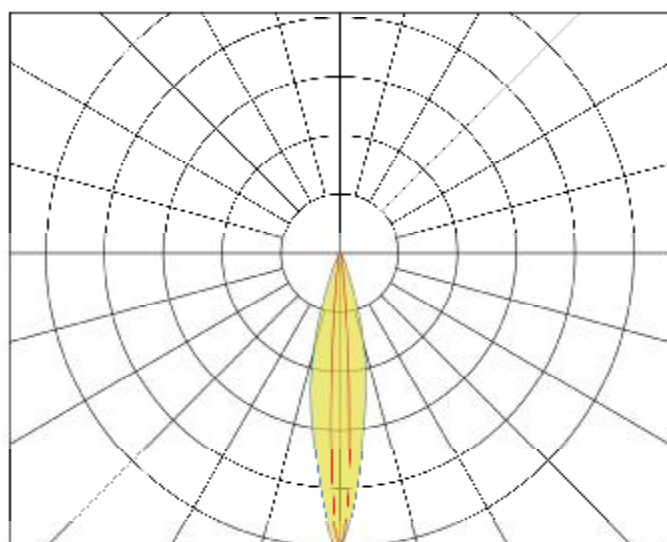

Note: The CREE XP-E LED emitter flux is 120lm @350mA

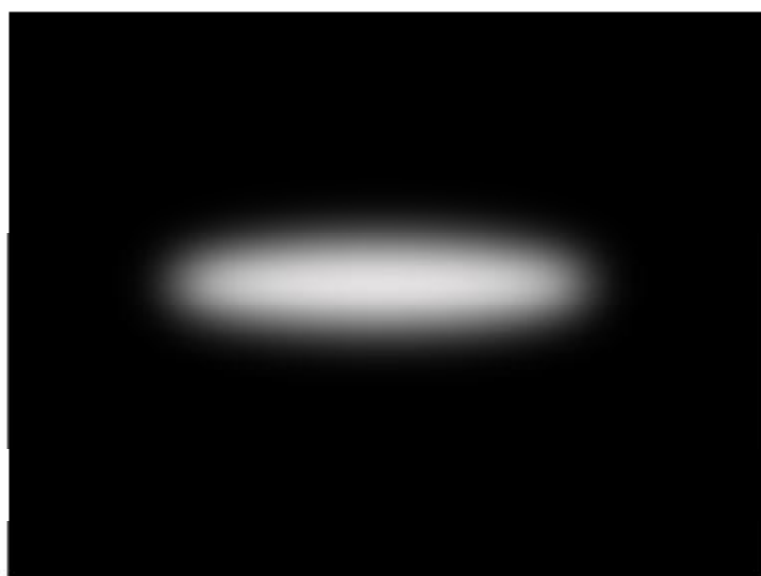



2D Drawings (unit:mm)

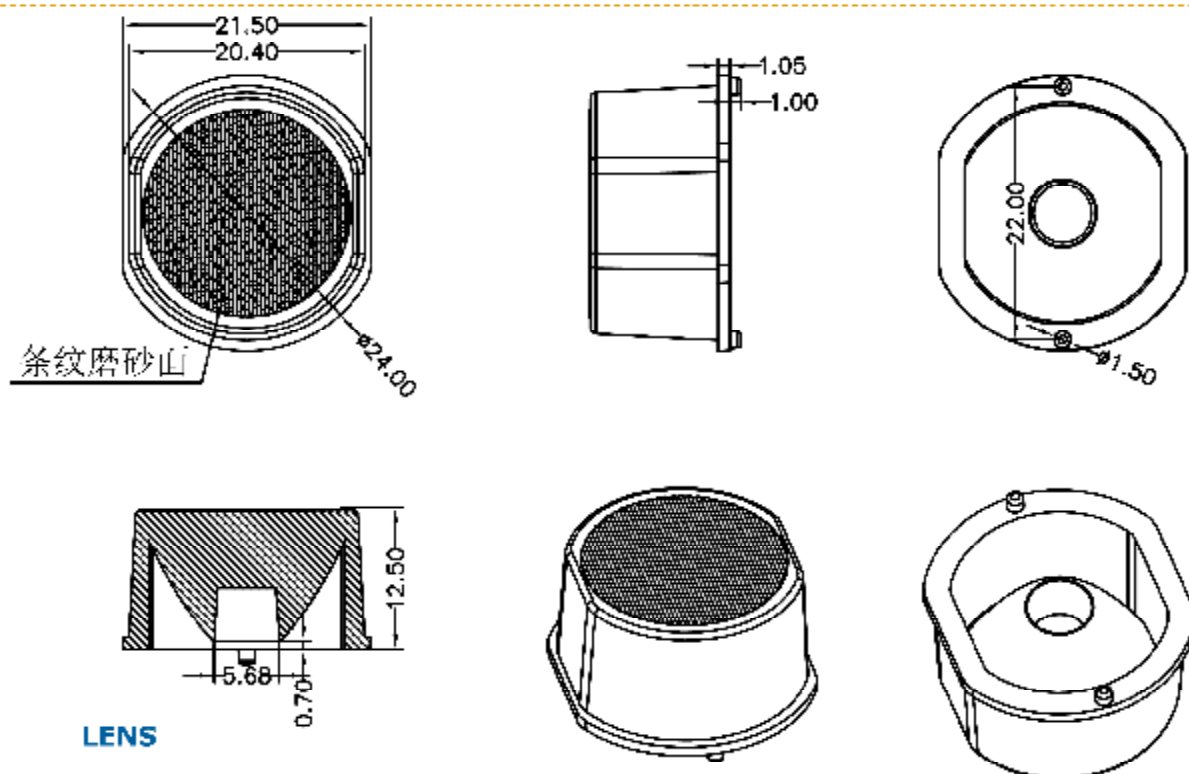

Optical Characteristics (for 3535 LED)

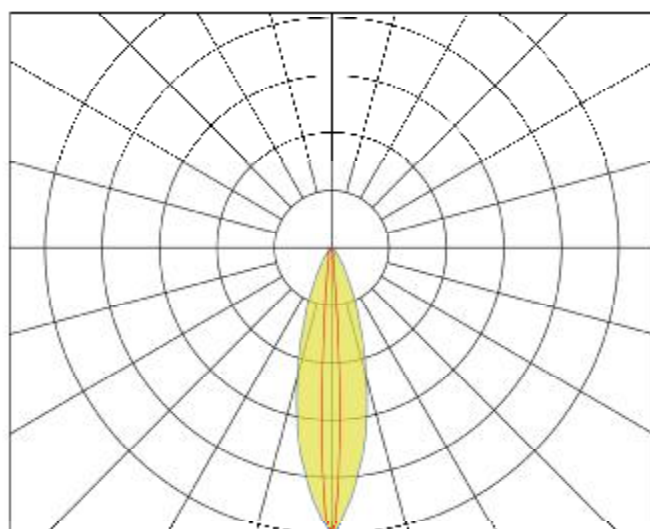

Note: The CREE XP-E LED emitter flux is 120lm @350mA

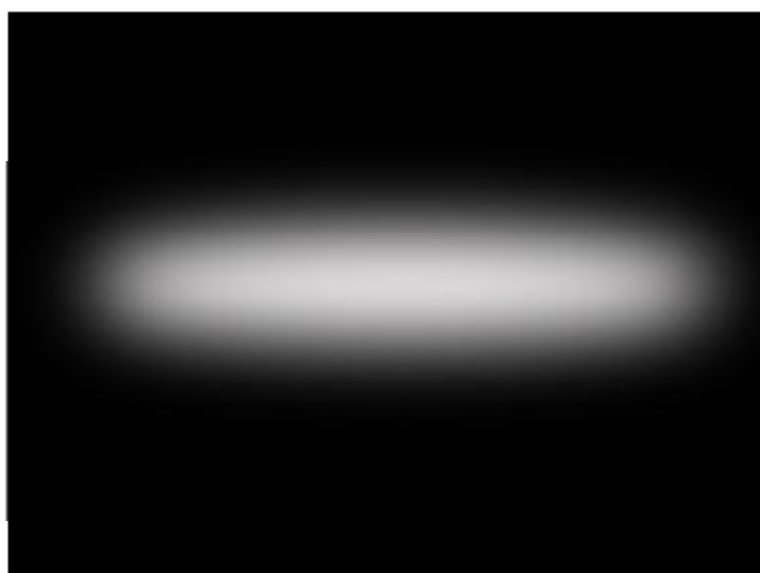



2D Drawings (unit:mm)

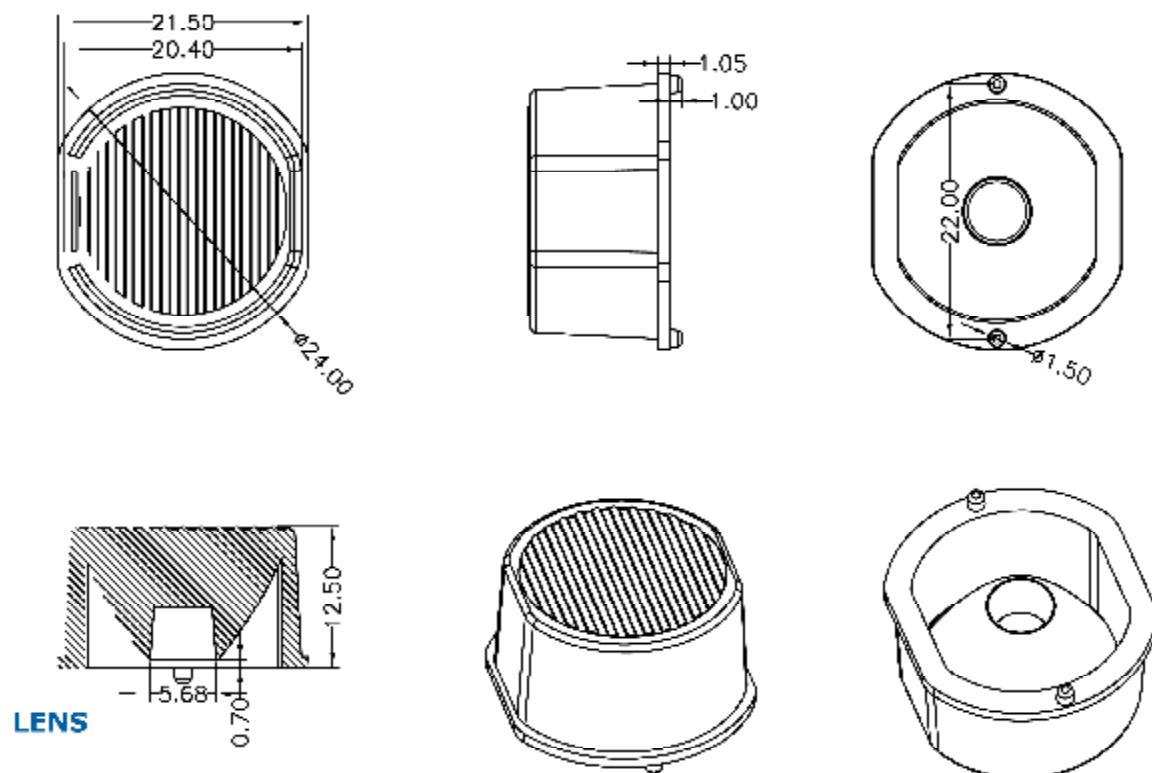

Optical Characteristics (for 3535 LED)

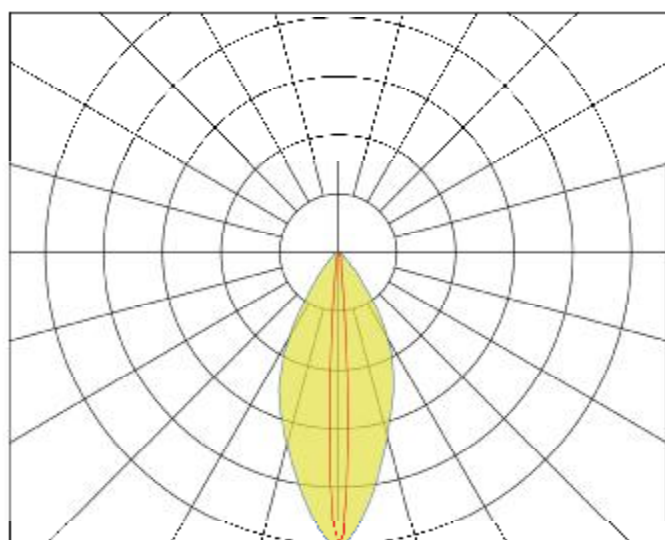

Note: The CREE XP-E LED emitter flux is 120lm @350mA

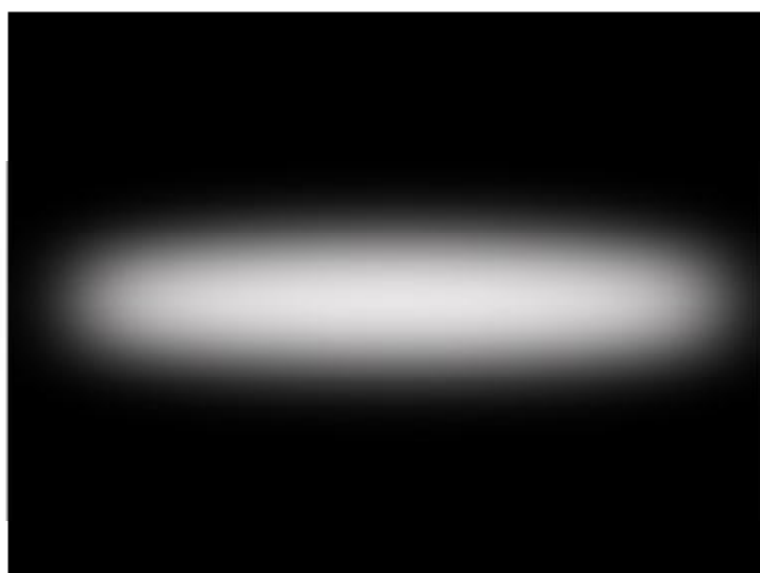



2D Drawings (unit:mm)

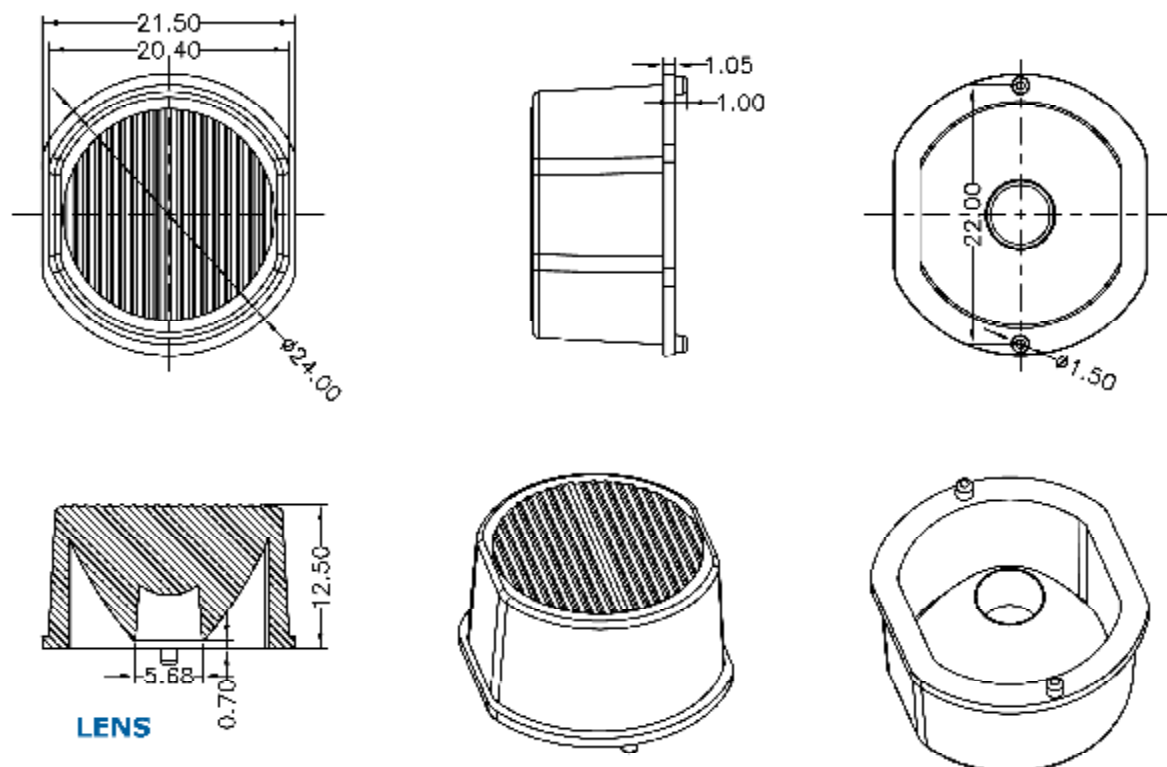

Optical Characteristics (for 3535 LED)

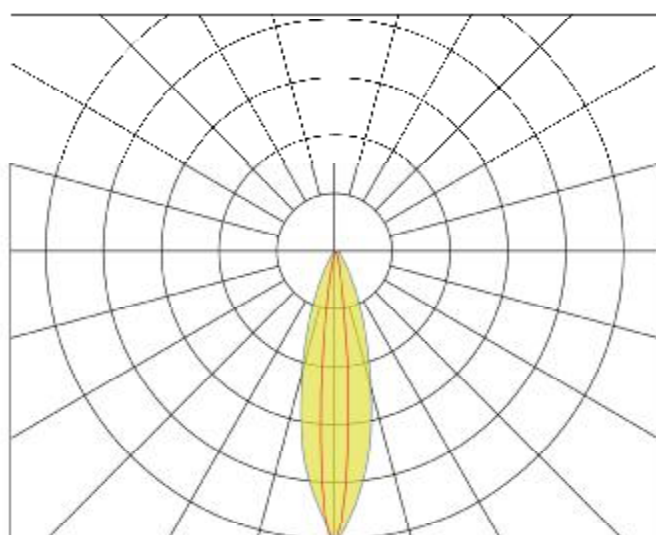

Note: The CREE XP-E LED emitter flux is 120lm @350mA

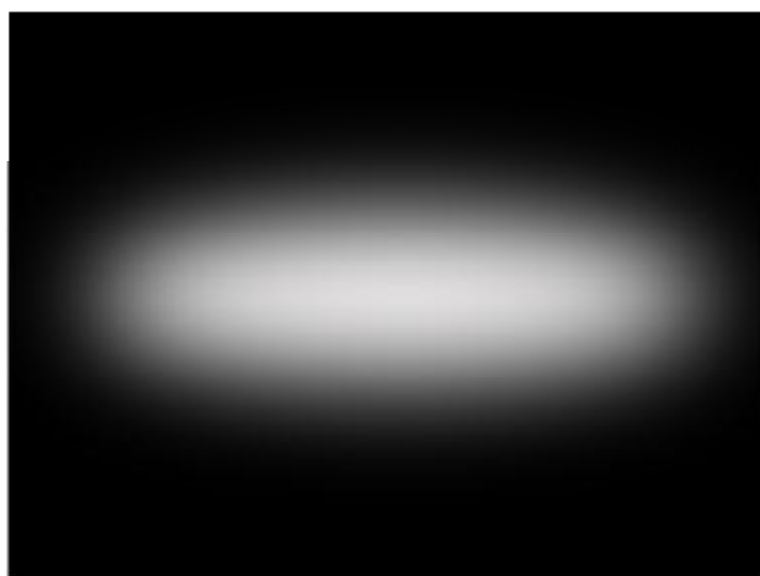



Package Information

Item	Quantity	Total	Size (long*width* high)
Tray	25pcs/tray	25pcs	—
Inner box	9 tray/inner box	225pcs	12.5*12.5*12.5 cm
Outer box	18 inner box/outer box	4050pcs	42.0*39.0*39.0 cm

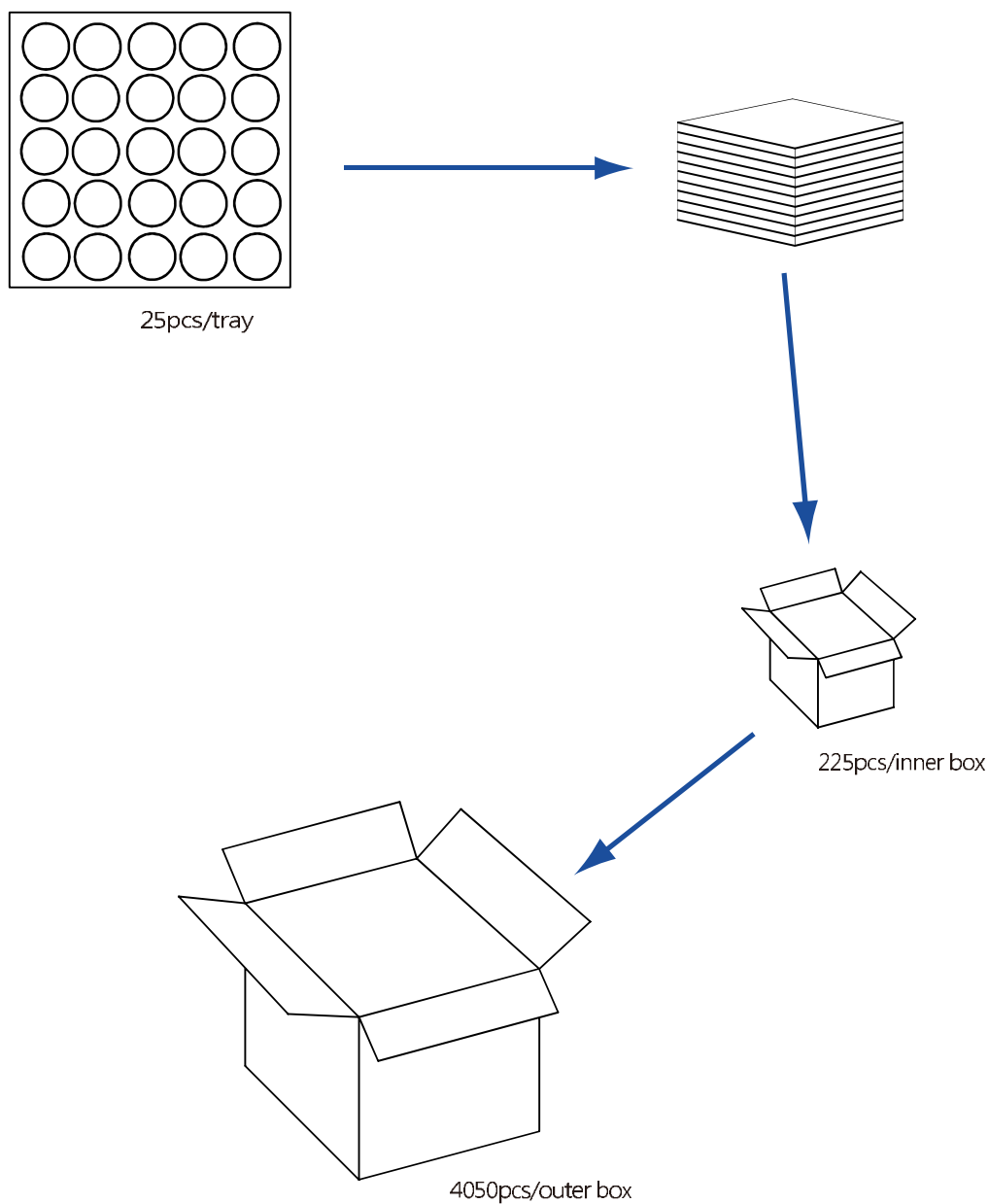



Product Nomenclature

